

49502-00 TENSION DEVICE FOR CHILD SAFETY INSTALLATION INSTRUCTIONS

BY SIMPLY FOLLOWING THESE STEP-BY-STEP INSTRUCTIONS, YOU WILL SOON BE ENJOYING YOUR NEW DRAPERY HARDWARE.

Getting Started:

Please read through all instructions carefully before you begin.

Unpack all materials making sure all components are included:



Tools You Will Need:

- Phillips screwdriver or drill with Phillips bit
- Optional anchors if needed

Assembling the 49502-00 Tension Device:

1. Place bead chain on the bottom groove of the Chainhold base.
2. Snap cover onto the base.
3. Pull the chain out of the groove.

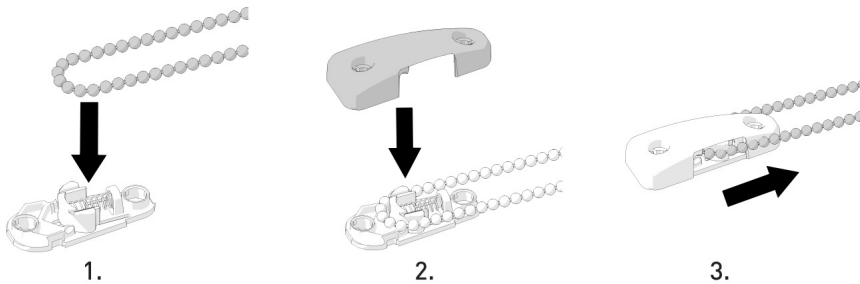

Installing the 49502-00 Tension Device:

1. Pull the Chainhold down until the chain is fully tensioned (plunger will be fully raised).
2. Mark screw hole locations.
3. Screw device into wall.

